

## Brickwork Support Systems

**HMS** Brickwork support systems are used for the secure and easy installation of masonry façades. The **HMS** masonry brackets are used to transfer the dead loads of non load bearing outer shell masonry walls to the load bearing inner walls of buildings. Load bearing masonry support brackets are fixed on concrete beams which carry the dead load of the facade. **HRST** Restraints ties or **HWT-M** wall ties are used along the rest of the storey height to secure the masonry facade against wind loads.

The following points should be carefully evaluated when designing a masonry facade: thickness of insulation and air gap; design of details, such as, wall areas, joints, external and internal corners, lintels above doors and windows, and columns. Many product variations are available for these situations, including the fixing of pre-cast brickwork lintels and prefabricated elements.

The thickness of the insulation together with the air gap make up the projection size that makes up the distance between structural backing and facing brick wall. The greater the distance is between the two layers, the larger has to be the projection K of the support brackets.

Brickwork support brackets are suitable for distances between leaves of 40 to 160 mm. The corresponding masonry support brackets come with projections K of 130 to 350 mm. Angle supports are used for any cavity sizes that are less than 40 mm.

In order to cover all the loads within the application of brick works installation, there are three load groups that the brackets can carry. The load categories are 3.5, 7.0 and 10.5 kN.



**FIX-U**  
Brickwork Support Bracket

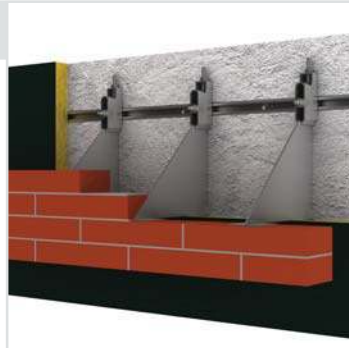

- Adjustable and easy to install brackets
- Projection sizes up to 350 mm
- Load capacity of up to 10.5 kN
- Fixing to concrete with anchor bolts and anchor channels

**HMCS**  
Brickwork Continuous Support



- Continuous masonry supports
- Projection sizes up to 230 mm
- Load capacity of up to 18.0 kN
- Fixing to concrete with anchor bolts and anchor channels

**HMS-AW**  
Restraint Channel

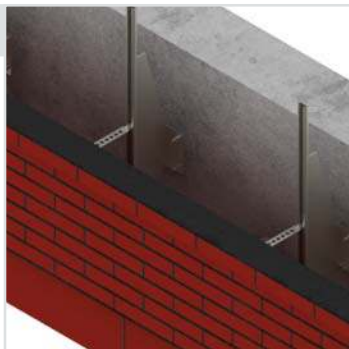

- Restraint channel for cladding on parapets
- Cavities of up to 145 mm
- Suitable for use with wall ties
- Quick and easy fixing

**FIX-S**  
Brickwork Support Bracket

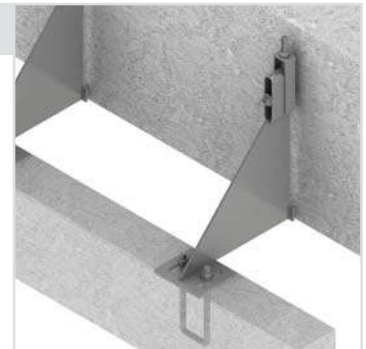

- Installation of prefabricated units
- For use over window and door openings
- Load capacity of up to 10.5 kN
- Suitable for use with anchor channels and U inserts



Sabanci University, Istanbul

### Brickwork Facade

A brickwork facade which is built with bricks, is formed out of a load bearing inner wall, an insulating layer and an outer wall. The outer wall cannot be used for load bearing purposes nor can it be used for attachments of various components. The outer wall is a design element that satisfies the aesthetics and also serves as a means of weather protection. The outer wall which is constructed of layers of brickwork needs to be supported at regular intervals. The load of the brickwork is transferred on to the inner load bearing wall by brickwork support brackets. Restraining of the outer wall is made with restraint wall ties. Therefore, both the inner and outer wall shells are connected to each other with load bearing brackets and restraint wall ties.

